

HIGHWAY GUARDRAIL

Hebei Innovat Building Materials Group Co., Ltd. is an enterprise specializing in manufacture and sale of high-quality metal products. Main products of INNOVAT GROUP: all kinds of steel products, aluminum products, copper products, high temperature and corrosion resistant alloy products, wire mesh products, metal products, high-precision cold-drawn and cold-rolled products, ultraprecise stamping and machined products, high-grade metal filter products, the overall solution of the tower tank filter device, etc.

INNOVAT GROUP implements comprehensive quality management and has complete production qualifications. We has passed ISO 9001 ISO 14001/ISO 45001 AS 9100 aerospace quality management system certification, and American Petroleum Institute (API) certification, British Lloyd's certification, EU AD2000-W0 and TUV SUD PED 2014/68/EU certification, etc.

Organizational structure:

Operation centers and R&D centers located at the 8th floor of Block B, Ziyu Park Plaza, Yuanxi Street, Qiaoxi District, Shijiazhuang city, Hebei Province,

Production bases located at Shahe county, Hebei and Anping county, Hebei respectively.

INNOVAT GROUP has established long-term and stable cooperative relations with many Fortune 500 companies such as Thyssenkrupp, 3M, IMEDCO, Kurtz, etc. We have accumulated more than 300 stable customers from 78 countries around the world.

INNOVAT GROUP is committed to providing high-quality products and services at competitive prices to customers around the world.

Highway guardrail

Description

Guardrail beams we supply are 10 gauge and 12 gauge materials, which process is going through flattening, punching, galvanizing or plastic coating, fabricating and shearing process.

We supply and manufacture beam guardrails in accordance with China National Standard JT/T281-1995(Corrugated Sheet Steel Beams For Expressway Guardrail - China), AASHTO M-180(Corrugated Sheet Steel Beams For Highway Guardrail - USA), RAL-RG620 (German) or any other International Standards. The base steel we use meets Steel Grade Q235B (equivalent to S235JR according to DIN EN 10025 and Gr. D according to ASTM A283M) or Q345 (S355JR / ASTM A529M 1994).

The company has advanced guardrail plate forming machine, which can realize the strip head removal, smoothing, punching, cutting, forming, leveling and other working procedure, so that the guardrail has good consistency, high processing accuracy, low production cost, which is widely recognized by the market.

The company has an advanced production line of plastic spraying and hot-dip galvanizing for guardrail. According to the different construction environment, corresponding surface treatment can be adopted to achieve good corrosion resistance, moisture resistance and weather resistance.

Specification

| Name | Specification | material | Surface treatment | Standard |
|------------------|-------------------------------------|------------------|---|-----------------|
| W beam | 3520*310* 85*2.5(2.67/2.7/3.0) mm | Q235/345/A2 6 | Zinc coating ≥ 550g/m2 or pvc coated | aashto/ast m |
| | 4130*310*85*2.5(2.67/2.7/3.0) mm | | | |
| | 4300*306*80*2.5(2.67/2.7/3.0) mm | | | |
| | 4300*310*75*2.5(2.67/2.7/3.0) mm | | | |
| | 4320*310*85*2.5(2.67/2.7/3.0) mm | | | |
| Thri beam | 4320*506*85*2.55(2.67/2.75/3/4) mm | Q235/345/A2 6 | Zinc coating ≥550g/m 2 or pvc coated | aashto/ast m |
| | 3300*506*80*2.55(2.67/2.75/3/4) mm | | | |
| | 4130*506*83*2.55(2.67/2.75/3/4) mm | | | |
| C post/spacer | 1800*150*75*25*5mm, | Q235/345/A2 6 | Zinc coating ≥ 550g/m2 or pvc coated | aashto/ast m |
| | 1500*100*50*25*5mm, | | | |
| | 1500*120*55*16*4/5mm, | | | |
| | 1700*150*110*18*4/4.5/5mm | | | |
| | 1750*120*55*16*4/5mm, | | | |
| | 1900*100*55*25*4/5mm and Customized | | | |

| | | | | |
|------------------------|--|------------------|---|-----------------|
| I post/spacer | H Post Normal size: 1830*157*82*5mm, 1830*157*82*5*7.4mm, | Q235/345/A2 6 | Zinc coating ≥ 550g/m2 or pvc coated | aashto/ast m |
| | 1800*150*100*5mm and Customized | | | |
| U Post/spacer | 1400/1750/1820*150*75*4/4.5/5mm, | Q235/345/A2 6 | Zinc coating ≥ 550g/m2 or pvc coated | aashto/ast m |
| | 1800/1830*176/178*76*4.5/5/6mm, | | | |
| | 1830*140*75*5/6mm, | | | |
| | 1680/2200*120*80*5/6mm, | | | |
| | 2000/1820*150*100*5mm and Customized | | | |
| Round post/spacer | 140x1176x4.5mm OR other length | Q235/345/A2 6 | Zinc coating ≥ 550g/m2 or pvc coated | aashto/ast m |
| Sigma post/spacer | 100*55*16*4 mm and Customized | Q235/345/A2 6 | Zinc coating ≥ 550g/m2 or pvc coated | aashto/ast m |
| End section | Fish tail/Single Buffer ends | Q235/345/A2 6 | Zinc coating ≥ 550g/m2 or pvc coated | aashto/ast m |
| Bolts&nuts &washers | M16*35/40/45/50 | Grade 8.8 | Grade 8.8 | aashto/ast m |
| Aluminum Reflectors | 125mm*70mm*75mm(THICK 1.9MM) | / | / | aashto/ast m |

Features

Easy installation

Prevent the mobile equipment from skidding off the road by redirecting it

Minimum the damage

High quality material and anti-rust surface for longer service life

Corrosion resistant

Can be repaired quickly after accident



Balanced Spiral conveyor belt

Supply samples

Quality Guaranteed

Fast reply within 24 hours

Reasonable factory price

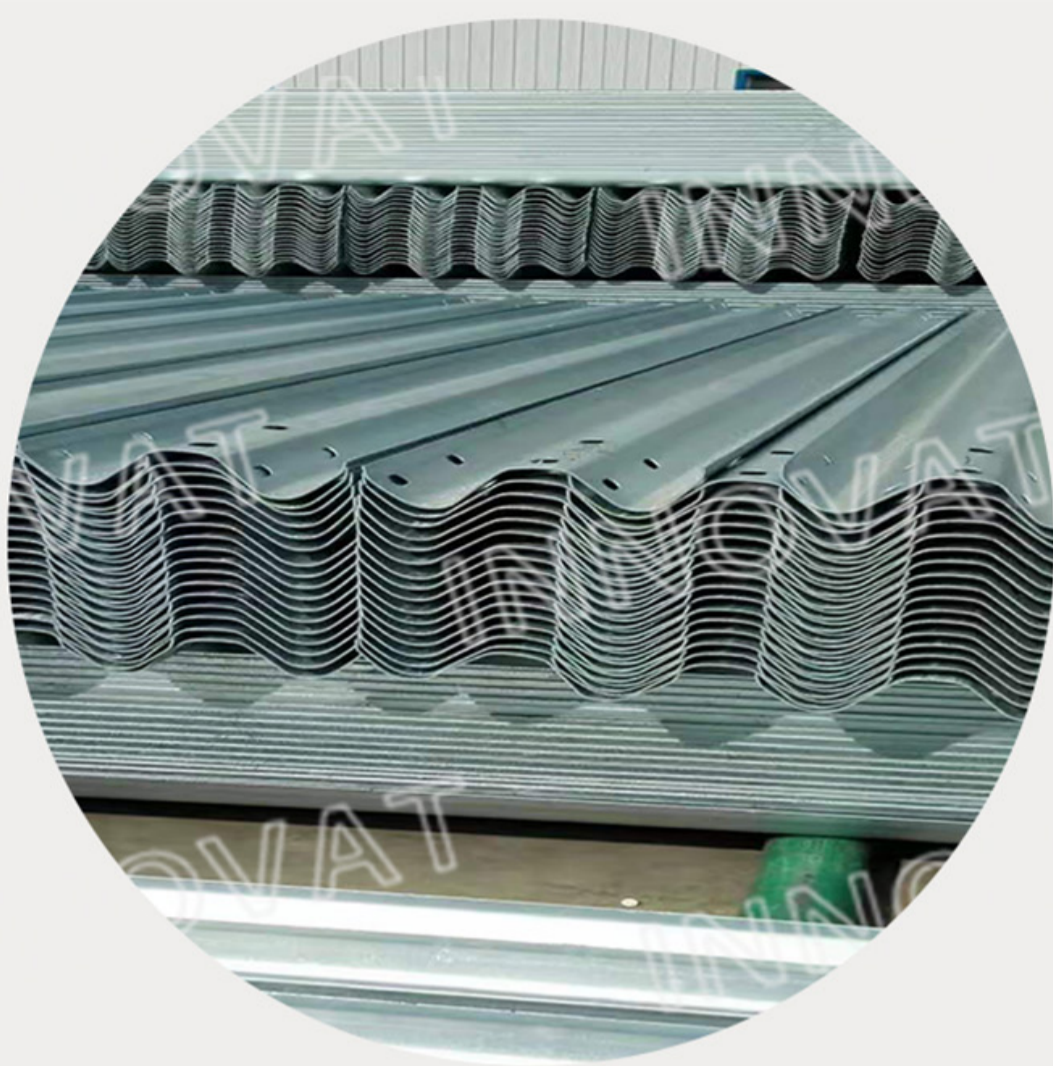

PROCESS

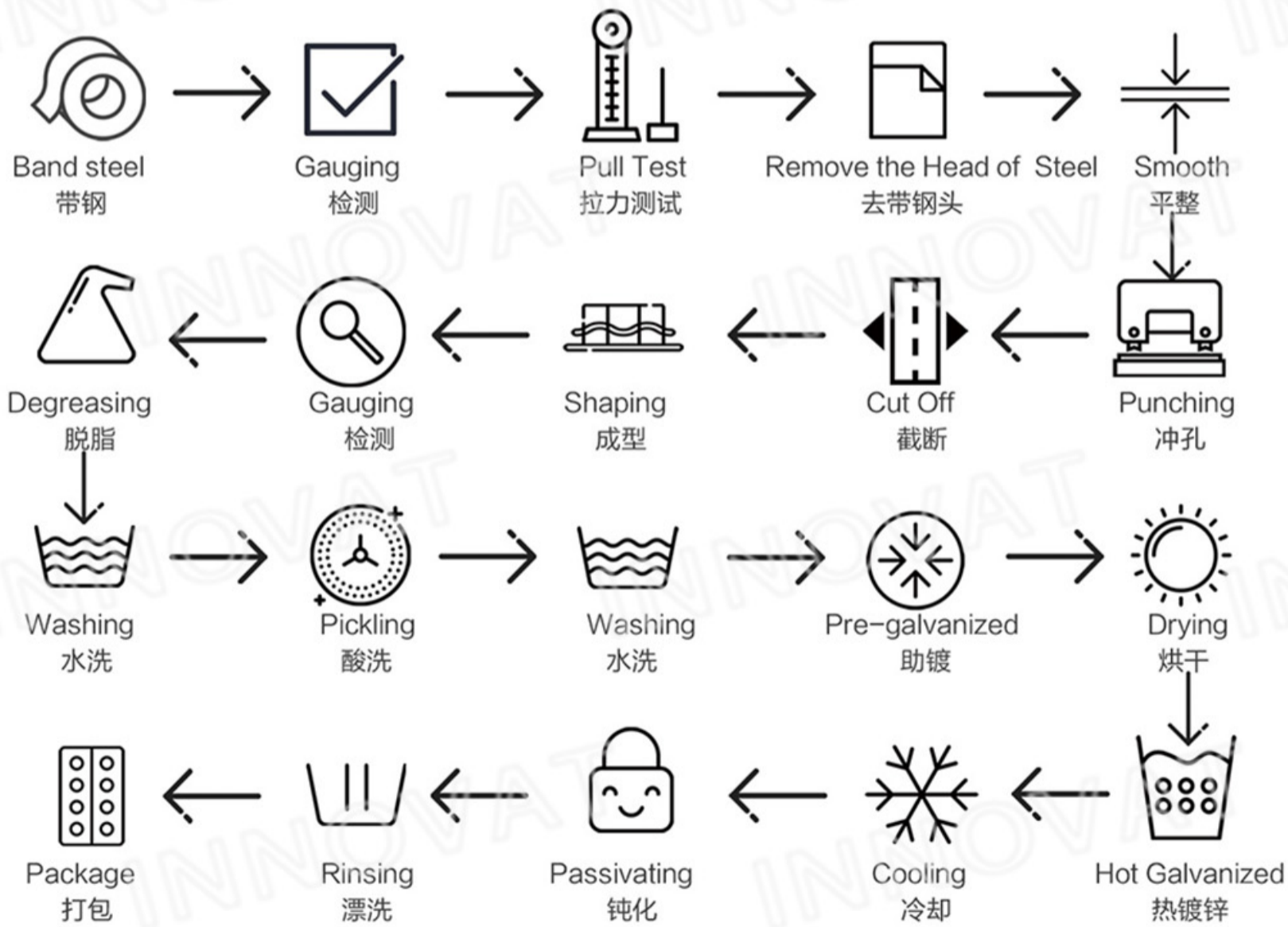



TERMINAL SECTION

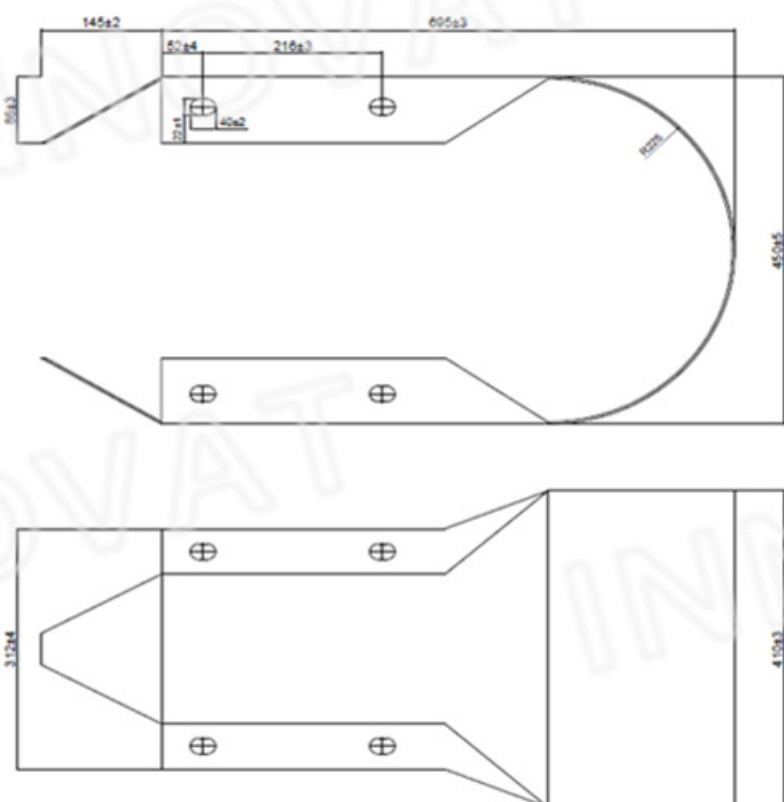

HE BEI INNOVAT BUILDING MATERIALS CO., LTD

ALL DIMENSIONS IN MM

| | |
|-------------------|--|
| Material | Q345 |
| Surface treatment | Hot dip galvanized 550g/m ³ |

TRANSITION

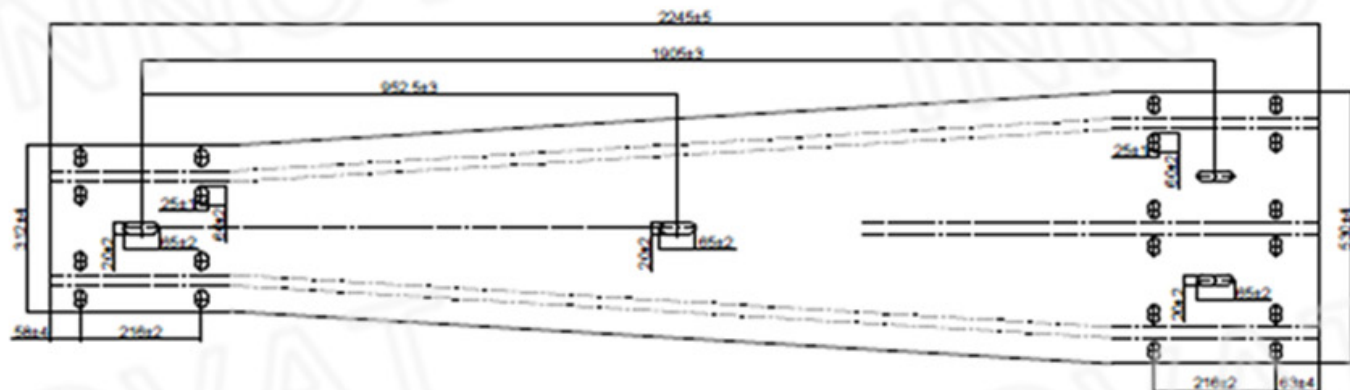

DWG 16



CONNECTOR

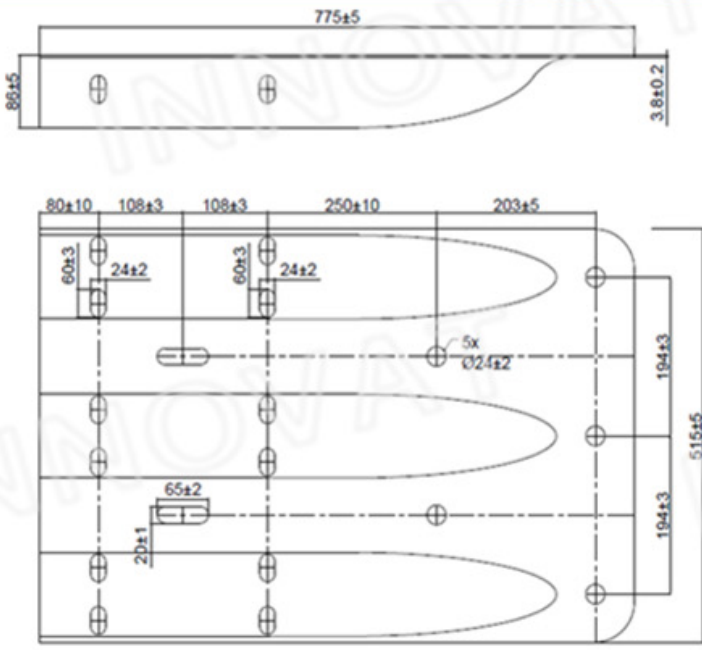

FISH TAIL

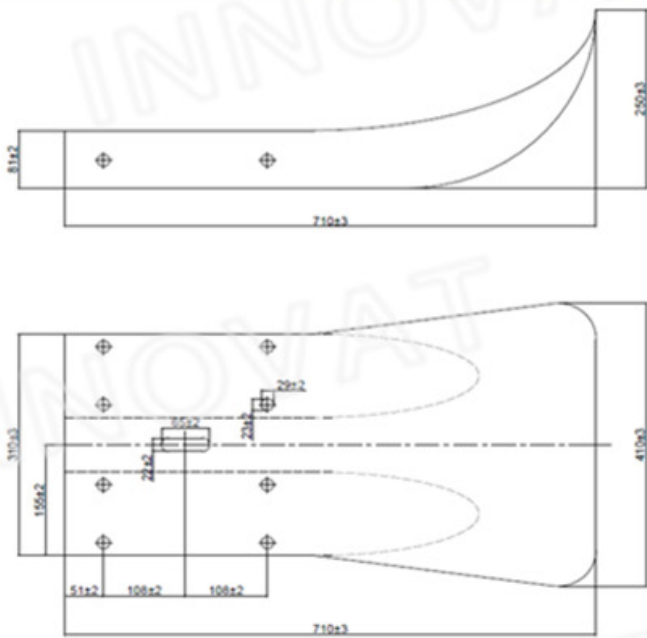

BOLTS & NUTS & WASHER

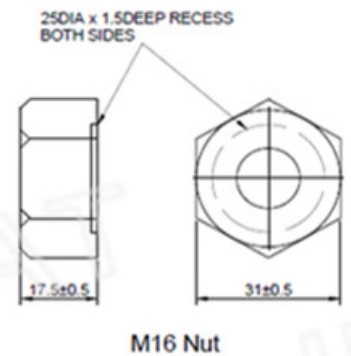
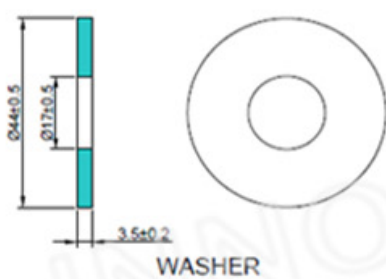
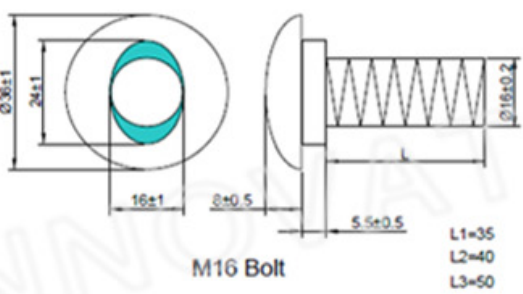

Drawing

W BEAM

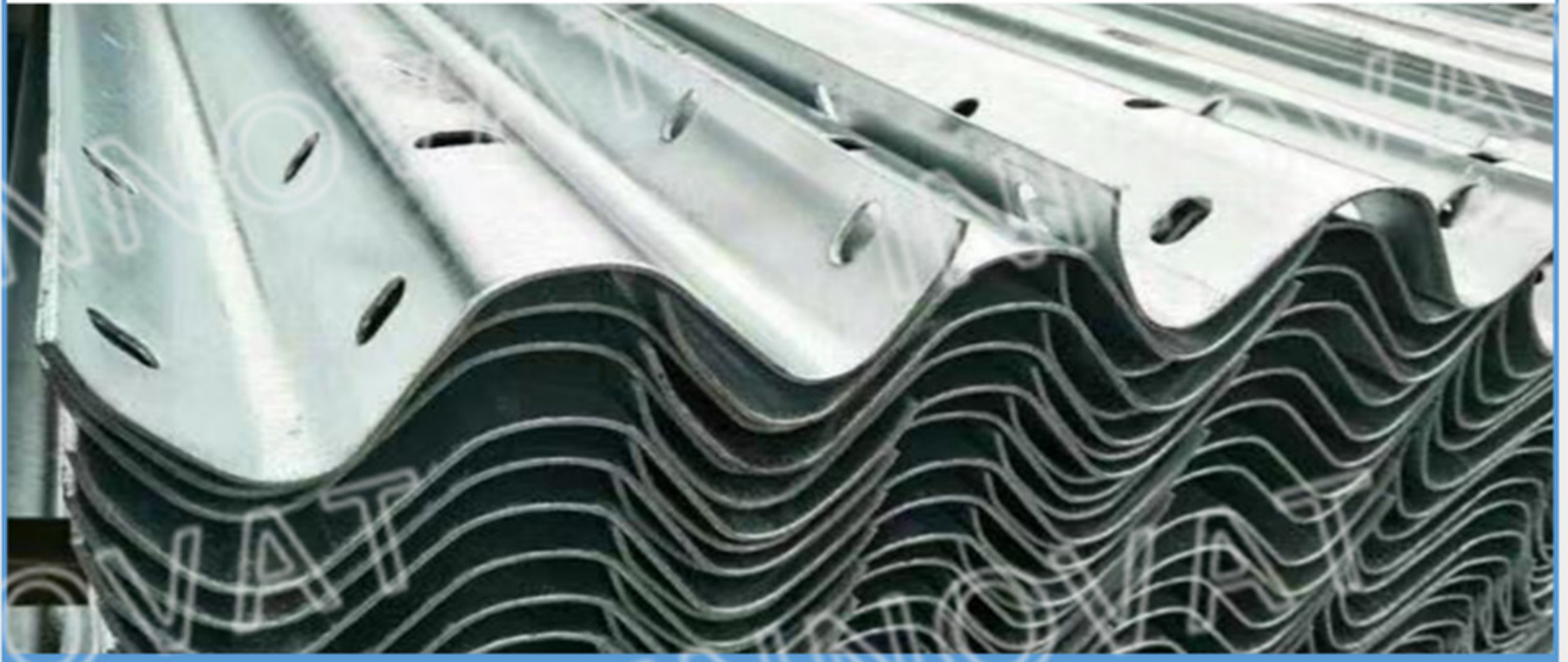
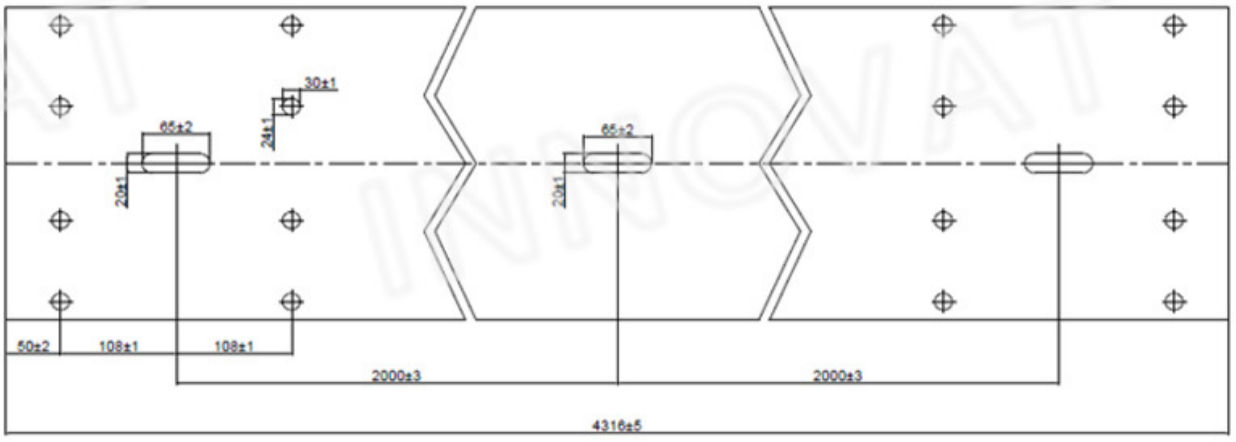

THRI BEAM

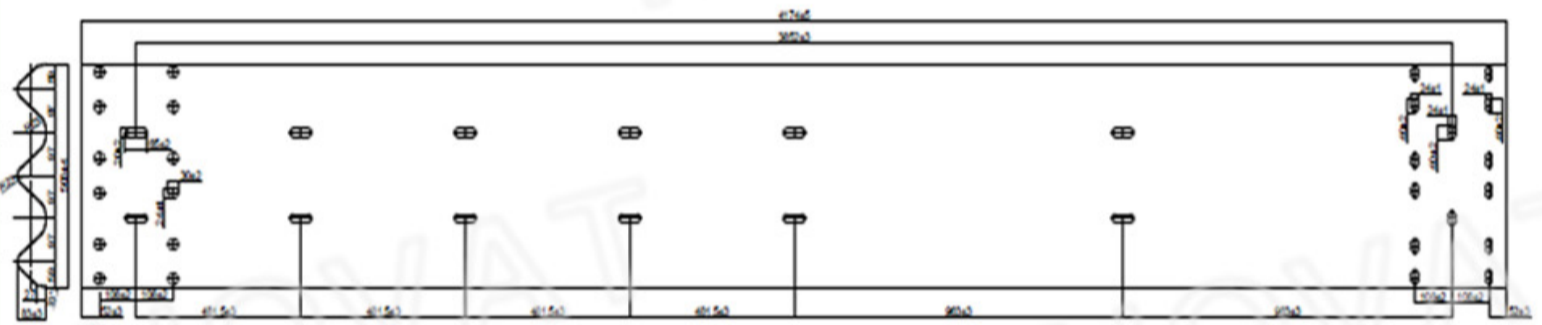

DWG 15

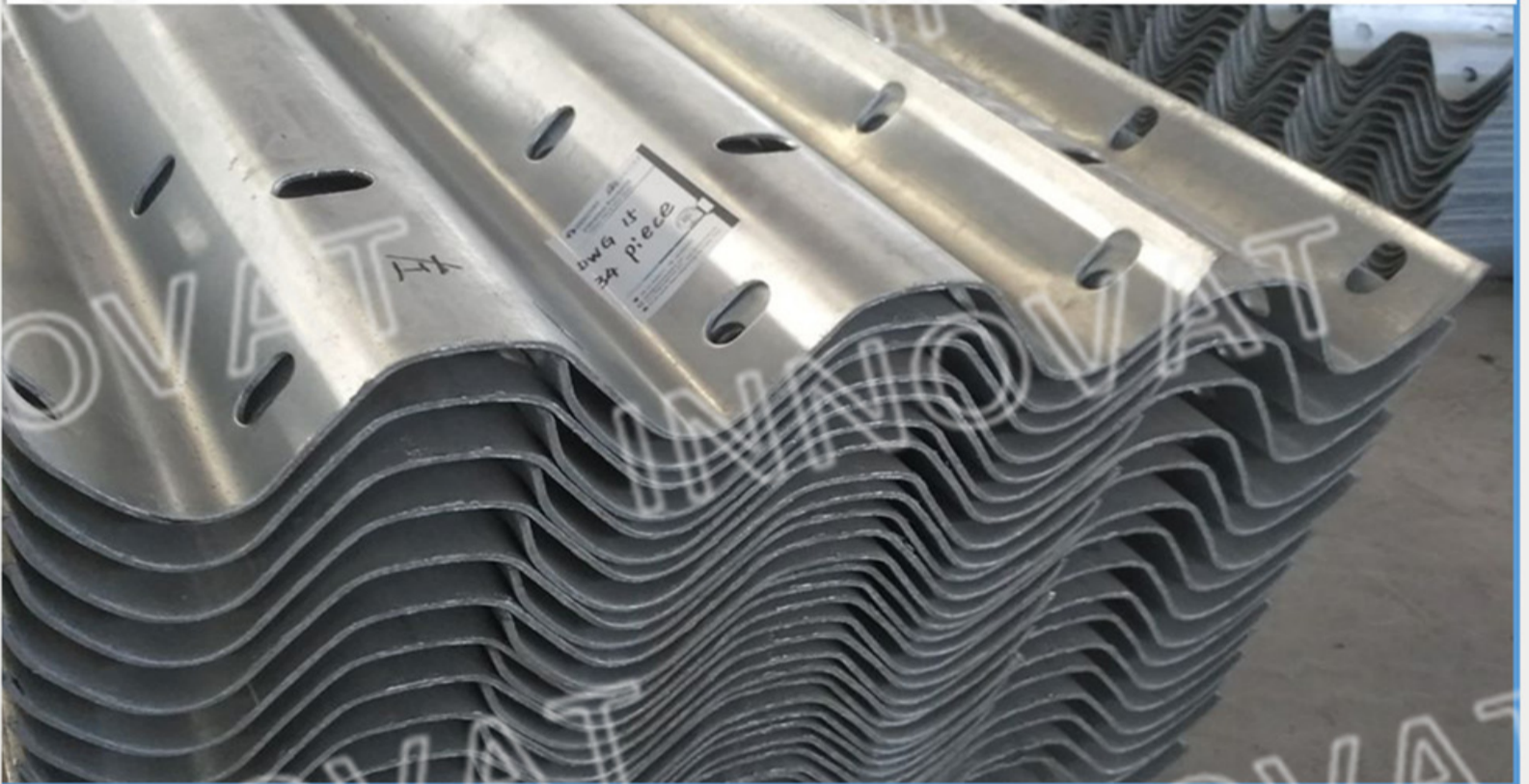

POST&BLOCK

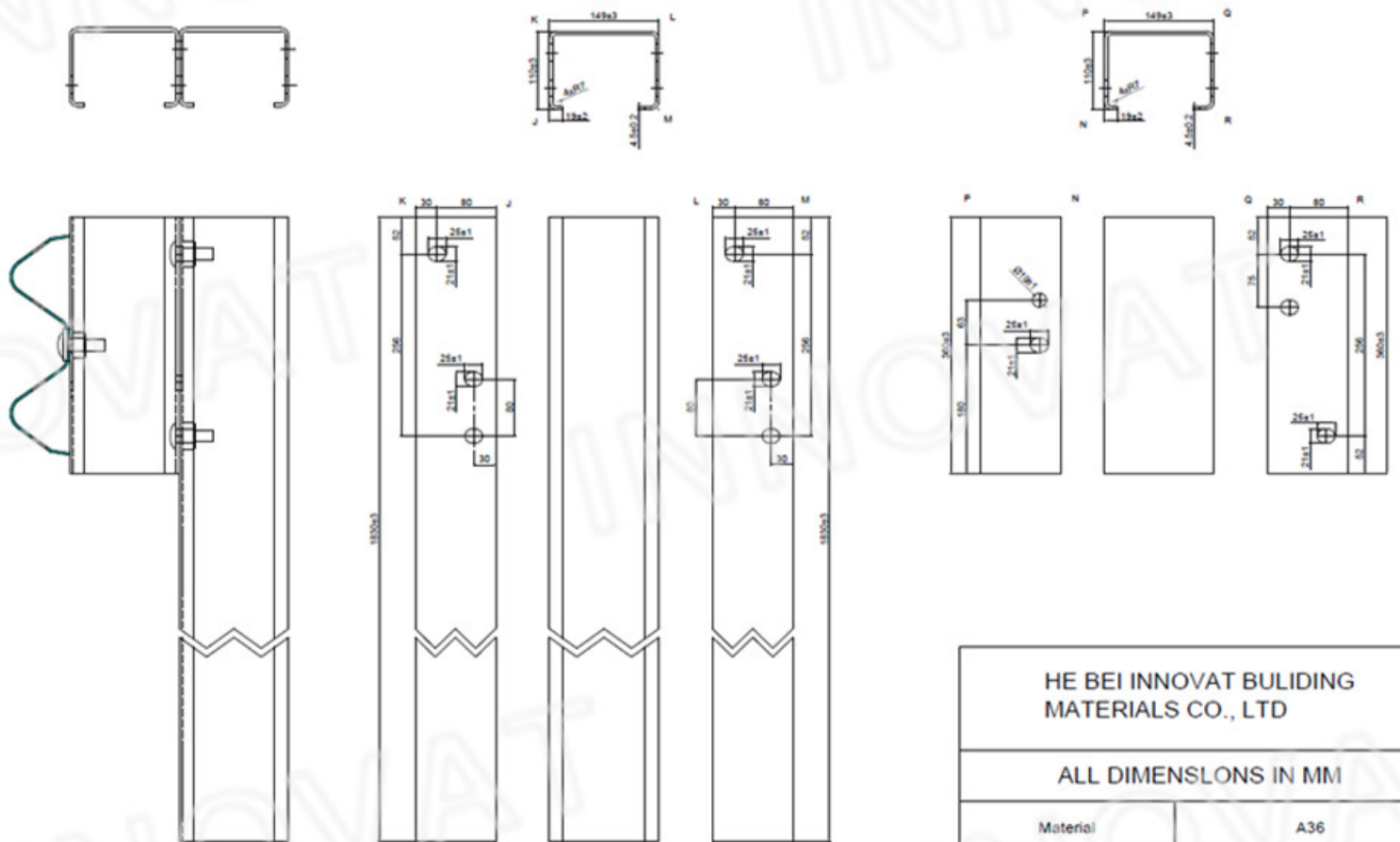

HE BEI INNOVAT BUILDING MATERIALS CO., LTD

ALL DIMENSLONS IN MM

Material

A36

DETAILS

highway guardrail

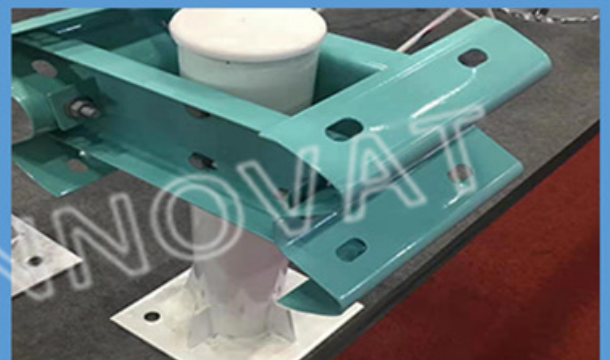
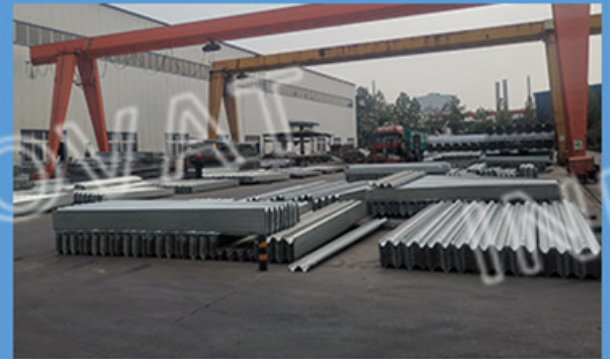

- WHY US -

-INNOVAT-HIGH WAY GUARDRAIL-

1. Keeping highway neat and tidy



2. Easy to install

3. Ensuring the safety of vehicles



Inspection



- PACKING -



In container



Wooden



With support



In bundle

- APPLICATION -

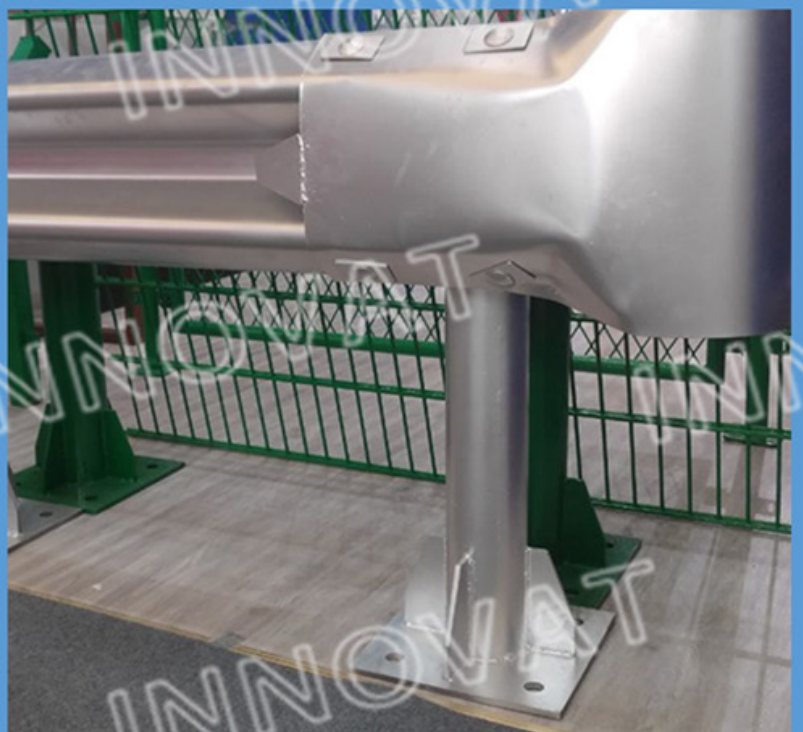

HEBEI INNOVAT BUILDING MATERIALS GROUP CO.,LTD

**New Office Address: 8th Floor, Block B, Dongsheng Ziyu Park Plaza,
Qiaoxi District, Shijiazhuang City, Hebei Province, China 050000**

Tel: +86 8754 2136 Fax: +86 311 83816848

Email: info@chinainnovat.com

Skype: [innovat.a](https://www.skype.com/name/innovat.a) Wechat: [Innovat-cn](https://www.wechat.com/p/innovat-cn)

whatsapp: +86 131 3115 9610 QQ: 1689475205

www.chinainnovat.com

www.unitedmetalmesh.com

www.chinainnovat.cn

Hebei Innovat Building Materials Group Co., Ltd.